



AeroTrach[®] Plus[®]

Anti-Static Valved Holding Chamber



For delivery of metered dose inhaler (MDI) medications to tracheostomy patients

Refer to the [instructions for use](#) for additional information.

Inhaler alone

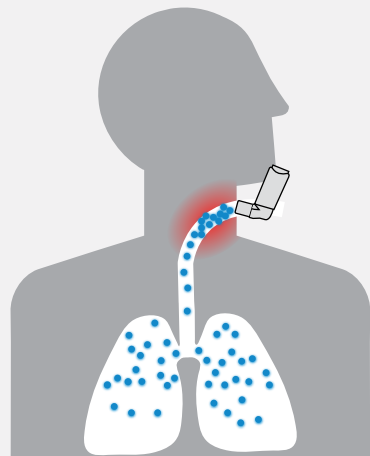

Inhaler + **AeroTrach Plus[®]**
Anti-Static Valved Holding Chamber

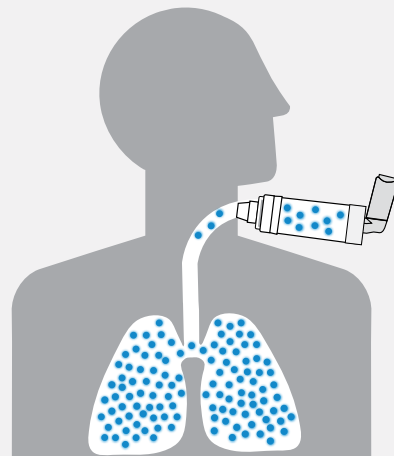

Use of a chamber delivers inhaler medication better than inhaler alone¹

Anti-static material improves reliability² and efficiency³ of medication delivery

Attaches firmly and comfortably to the 15mm connector on a tracheostomy tube

Can be used with most commonly prescribed MDIs

How to Use

1 Remove cap and shake inhaler.

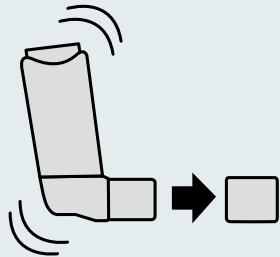

2 Insert inhaler into chamber.

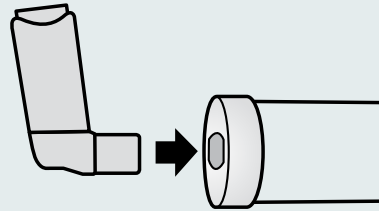

3 Connect chamber to tracheostomy tube.

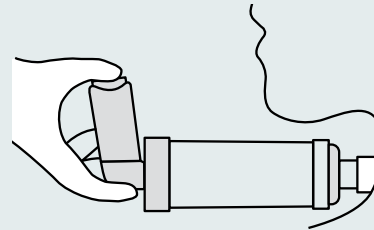

4 Press inhaler once at beginning of a slow inhalation. Hold in place for 5-6 breaths.

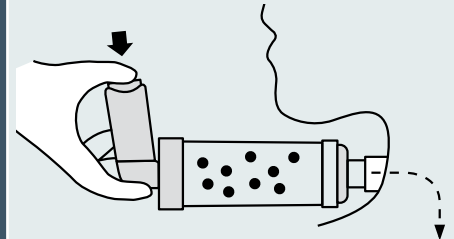

How to Clean

1 Remove back piece.

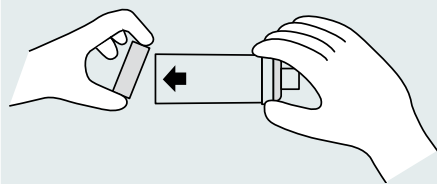

2 Wash in soapy water for 15 minutes. Rinse in clean water.



3 Air dry thoroughly.

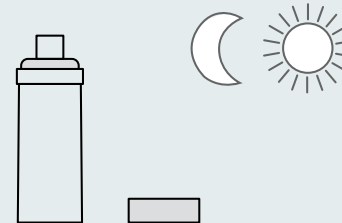

4 Reassemble.

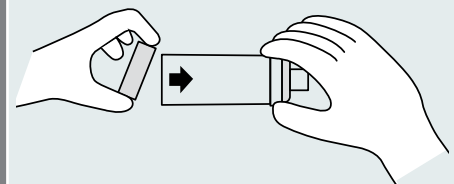

This chamber can be disinfected in a 1:10 bleach to water solution for 30 minutes. Refer to the [instructions for use](#) for additional information.



TRUDELL MEDICAL
UK LIMITED



Designed and
Developed in Canada

Manufactured in Canada with
USA and Canadian parts.

AeroTrach
Plus

Anti-Static Valved Holding Chamber

